

MMFMT Series



Technical specification

Application:	Manifold mounting medium to high pressure filter
Port size:	15 mm
Flow rate:	max. 110 l/min
Working pressure:	max. 315 bar
Burst pressure:	min. 950 bar
Element collapse pressure:	21 or 210 bar
By-pass opening pressure:	Δp 6 bar + 10%
Clogging indicator setting:	Δp 5 bar \pm 10%
Seals:	Perbunan (NBR, -10°C to 100°C)
Material:	Steel head & bowl
Compatibility:	Suitable for mineral oils, lubrication oils, non-flam fluids, synthetic and rapidly biodegradable oils (for use with water, please contact our technical dept.)
Tested according to ISO standards:	ISO2941 Collapse/burst resistance ISO2942 Fabrication integrity ISO2943 Material compatibility integrity ISO3723 Method for end load test ISO3724 Flow fatigue characteristics ISO3968 Pressure drop vs. Flow ISO16889 Multi-pass (filtration performance)

Technical specification subject to change without prior notice. Other specification on request. 2013/07/23

Pressure drop graphs (Δp)

Pressure drop of filter housing (mainly depending on port size)

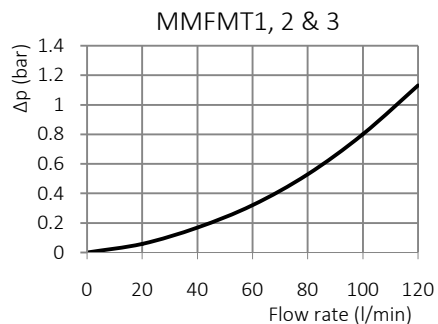

Pressure drop of clean filter elements (fibreglass filter media)

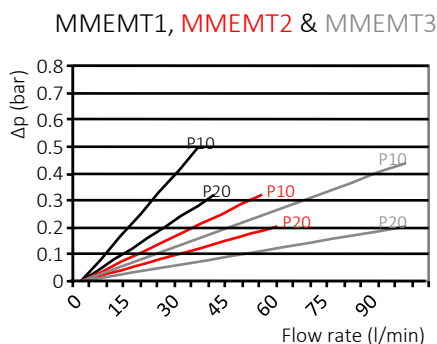
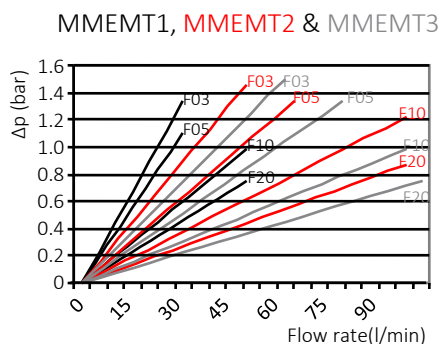

The test fluid has a density of 0.86 kg/dm³ and a kinematic viscosity of 30 mm²/s.

Technical specification subject to change without prior notice. Other specification on request. 2013/07

Dimensional drawings

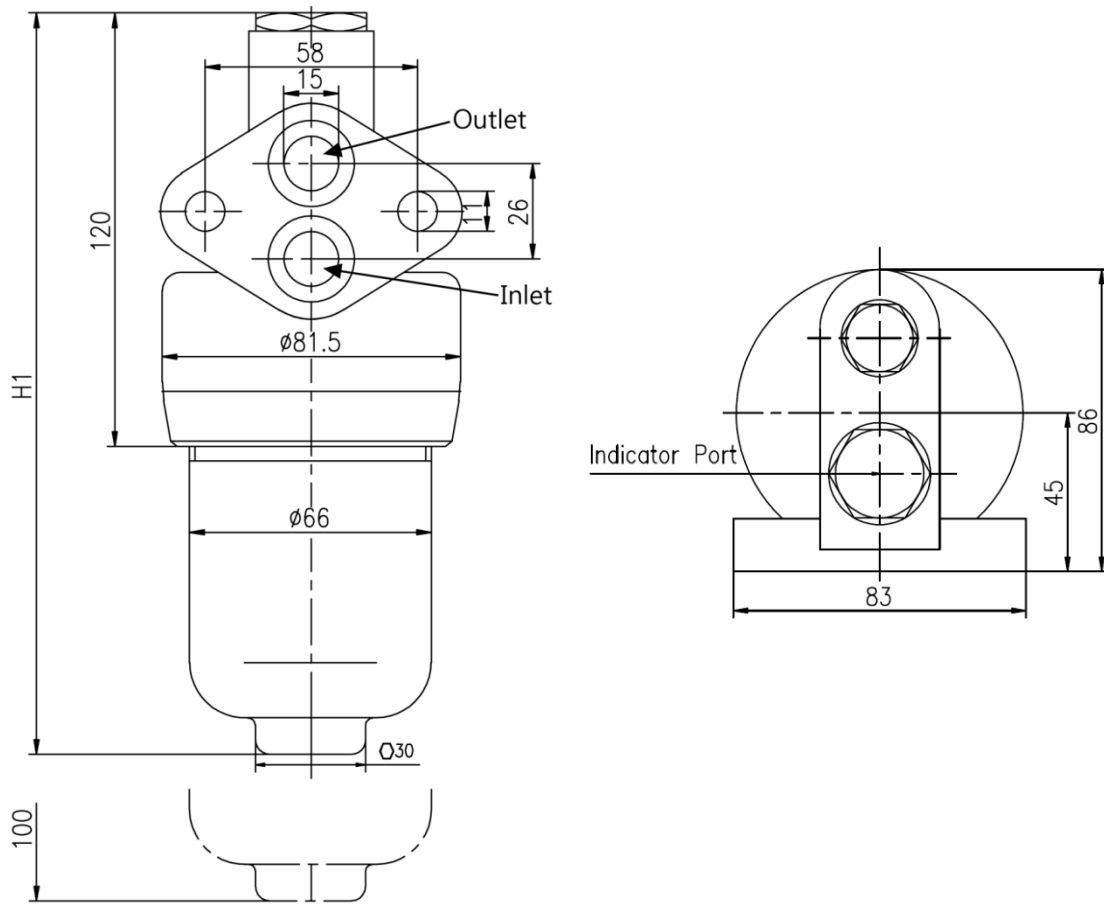

Type	H1	O-ring
MMFMT2	194	19X2.65
MMFMT3	225	19X2.65
MMFMT4	320	19X2.65

Technical specification subject to change without prior notice. Other specification on request 013/07/23

Order information

Filter assembly part number

Housing					Element	Accessories		
Type	Size	Connection	By-pass	Seal	Media	Indicator	Special	
MMFMT	Table 1	Table 2	Table 3	Table 4	Table 5	Table 6	X	
Example	MMFMT	2	NA	11	B	M03	V50	X

Element part number

Element			
Type	Size	Seal	Media
MMEMT	Table 1	Table 4	Table 5
Example	MMEMT	2	B M03

Tables

Table 1	
Size	Flow rate (l/min)
MMFMT2	30
MMFMT3	60
MMFMT4	110

Table 2		
Connection	Size	
NA	15 mm	
•		MMFMT1
•		MMFMT2
•		MMFMT3

Table 3	
By-pass	Open pressure
00	No by-pass
11	6.0 bar
X	Special

Table 4	
Seal	Material
B	Buna
V	Viton

Table 5			
Media	Material	Filtration	Collapse
P10	Cellulose	10 µm	21 bar
P20	Cellulose	20 µm	21 bar
M03	Fibreglass	3 µm	21 bar
M05	Fibreglass	5 µm	21 bar
M10	Fibreglass	10 µm	21 bar
M20	Fibreglass	20 µm	21 bar
H03	Fibreglass	3 µm	210 bar
H05	Fibreglass	5 µm	210 bar
H10	Fibreglass	10 µm	210 bar
H20	Fibreglass	20 µm	210 bar
Y25	Wire mesh	25 µm	21 bar
Y60	Wire mesh	60 µm	21 bar
Y90	Wire mesh	90 µm	21 bar
Y125	Wire mesh	125 µm	21 bar
Z25	Wire mesh	25 µm	210 bar
Z60	Wire mesh	60 µm	210 bar
Z90	Wire mesh	90 µm	210 bar

Table 6		
Indicator	Pressure	Type
V50	5 bar	Visual
E50	5 bar	Visual / Electrical

Technical specification subject to change without prior notice. Other specification on request. 2013/07/23