

MMFRB Series



Technical specification

Application:	Tank-top return filter with air breather
Ports:	G ½" to G 1"
Flow rate:	max. 140 l/min
Working pressure:	max. 10 bar
Burst pressure:	min. 21 bar
Element collapse pressure:	10 bar
By-pass opening pressure:	Δp 1.7 bar \pm 10%
Seals:	Perbunan (NBR, -10°C to 100°C)
Material:	Aluminium head, polyamide bowl and cover
Compatibility:	Suitable for mineral oils, lubrication oils, non-flam fluids, synthetic and rapidly biodegradable oils according to ISO2943 (for use with water, please contact our technical dept.)
Tested according to ISO standards:	ISO2941 Collapse/burst resistance ISO2942 Fabrication integrity ISO2943 Material compatibility integrity ISO3723 Method for end load test ISO3724 Flow fatigue characteristics ISO3968 Pressure drop vs. Flow ISO16889 Multi-pass (filtration performance)

Technical specification subject to change without prior notice. Other specification on request 013/07/23

Pressure drop graphs (Δp)

Pressure drop of filter housing (mainly depending on port size)

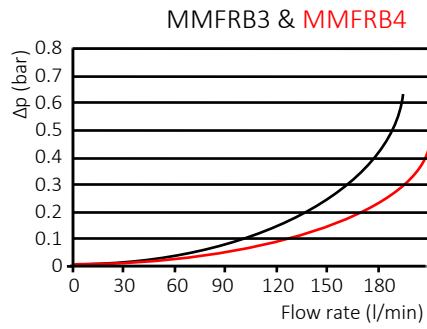
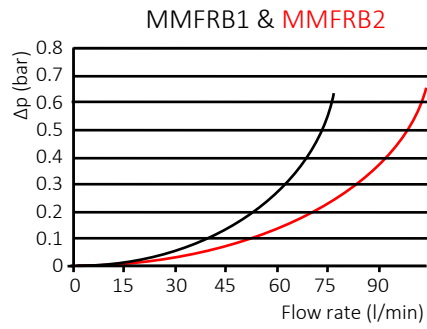

Pressure drop of clean filter elements (by filter media)

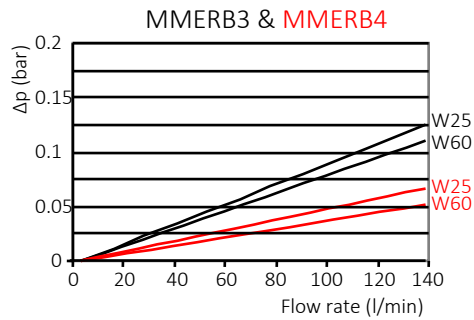
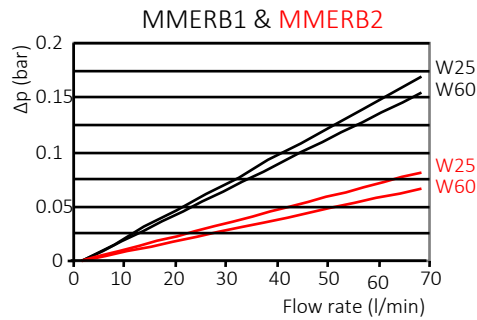
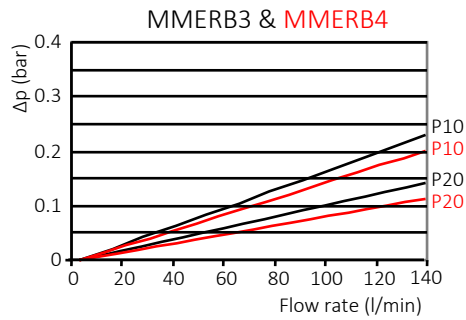
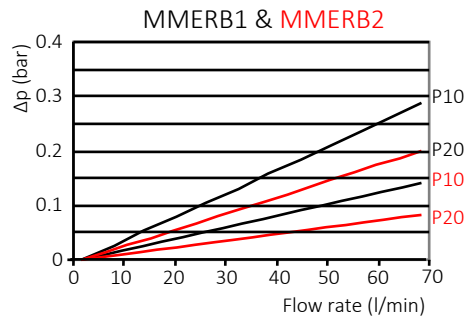
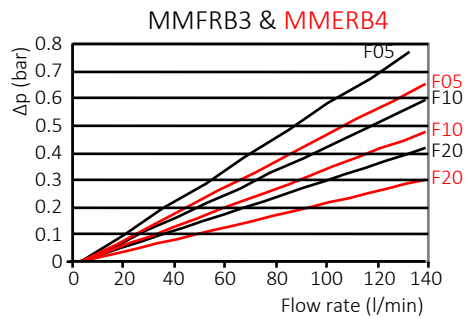
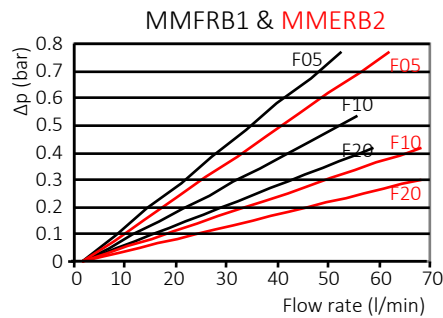

The test fluid has a density of 0.86 kg/dm³ and a kinematic viscosity of 30 mm²/s.

Technical specification subject to change without prior notice. Other specification on request. 2013/07/23

Dimensional drawings

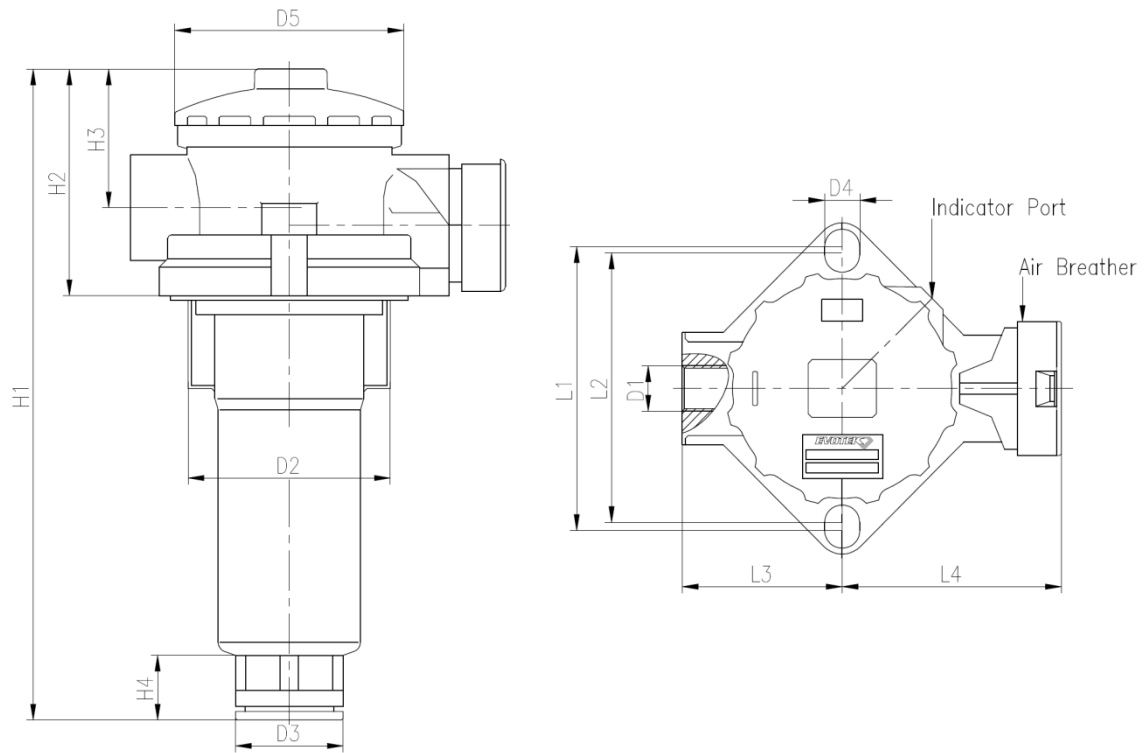

Type	D1	D2	D3	D4	D5	H1	H2	H3	H4	L1	L2	L3	L4
MMFRB1	G ½"	63	28	11	75	150	67	41	21	88	86	51	60
MMFRB2	G ¾"	63	28	11	75	247	67	41	21	88	86	51	60
MMFRB3	G ¾"	85	38	11	105	267	89	59	23	115	110	70	82
MMFRB4	G 1"	85	38	11	105	367	89	59	23	115	110	70	82

Technical specification subject to change without prior notice. Other specification on request 013/07/23

Order information

Filter assembly part number

		Housing				Element		Accessories	
		Type	Size	Connectio	Seal	By-pass	Media	Gauge	Breather
		MMFRB	Table 1	Table 2	Table 3	Table 4	Table 5	Table 6	Table 7
Example	MMFRB	1	BB	B	06	P10	PA	Y	

Element part number

Element					
Type	Size	Seal	By-pass	Media	
MMERB	Table 1	Table 3	Table 4	Table 5	
Example	MMERB	1	B	06	P10

Tables

Table 1	
Size	Flow rate (l/min)
MMFRB1	40
MMFRB2	60
MMFRB3	110
MMFRB4	140

Table 2				
Connectio			Size	
BB	BC	BD		
G 1/2"	G 3/4"	G 1"		
•				MMFRB1
	•			MMFRB2
		•		MMFRB3
			•	MMFRB4

Table 3	
Seal	Material
B	Buna
V	Viton

Table 4	
By-pass	Open pressure
00	No
06	1.7 bar

Table 5			
Media	Material	Filtration	Collapse
P10	Cellulose	10 µm	10 bar
P20	Cellulose	20 µm	10 bar
F05	Fibreglass	5 µm	10 bar
F10	Fibreglass	10 µm	10 bar
F20	Fibreglass	20 µm	10 bar
W25	Wire mesh	25 µm	10 bar
W60	Wire mesh	60 µm	10 bar
W90	Wire mesh	90 µm	10 bar

Table 6		
Indicator	Pressure	Type
00	-	None
PA	0 – 10 bar	Axial gauge
PR	0 – 10 bar	Radial gauge
R15	1.5 bar	Pressure switch

Table 7	
Breather	Type
N	None
Y	With air breather