

MMEST Strainer Series

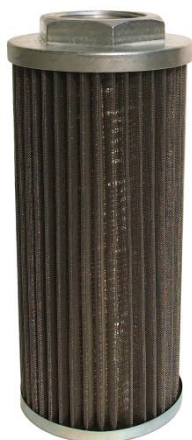

Technical specification

Application:	Suction strainers for in-tank mounting
Port size:	G ½" to G 3"
Flow rate:	max. 500 l/min
By-pass opening pressure:	Δp 0.3 bar \pm 10%
Temperature range:	-10 °C to 100 °C
Material:	Aluminium connector, zinc plated steel end caps & core
Compatibility:	Suitable for mineral oils, lubrication oils, non-flam fluids, synthetic and rapidly biodegradable oils according to ISO2943 (for use with water, please contact our technical dept.)
Tested according to ISO standards:	ISO2942 Fabrication integrity ISO2943 Material compatibility integrity ISO3723 Method for end load test ISO3968 Pressure drop vs. Flow

Technical specification subject to change without prior notice. Other specification on request. 2013/07/23

Pressure drop graphs (Δp)

Pressure drop of clean filter elements (wire mesh filter media)

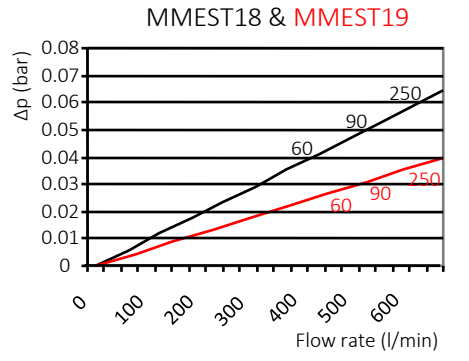
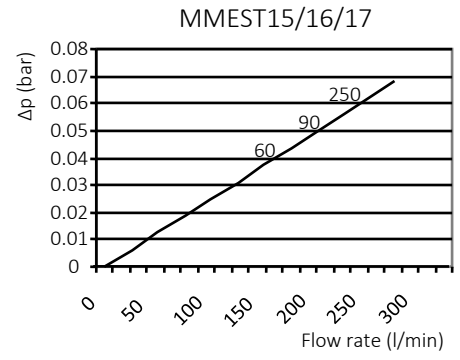
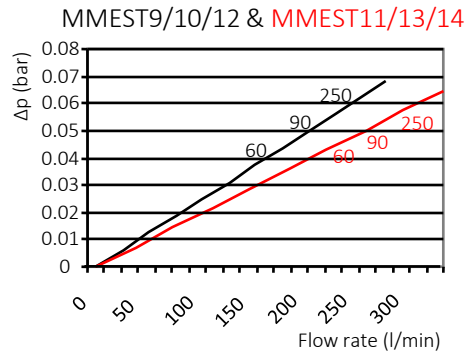
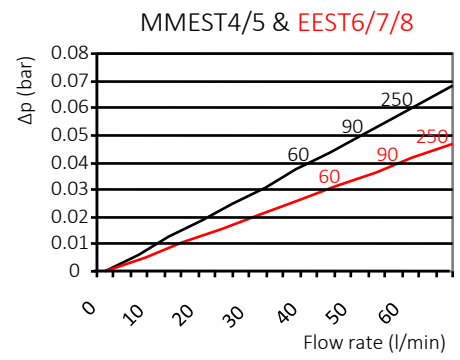
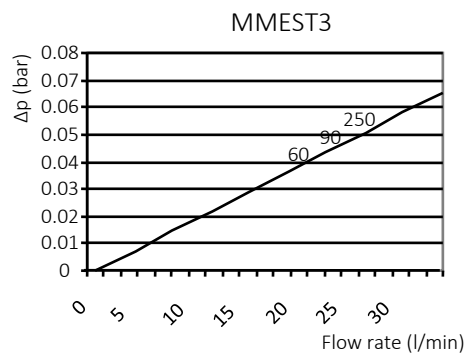

The test fluid has a density of 0.86 kg/dm³ and a kinematic viscosity of 30 mm²/s.

Technical specification subject to change without prior notice. Other specification on request. 2013/07/23

Dimensional drawings

Type	D1	D2	H1	H2	CH
MMEST3	G ½"	71	100	13	42
MMEST4	G ¾"	71	100	13	42
MMEST5	G ¾"	71	145	13	42
MMEST6	G 1"	71	145	13	42
MMEST7	G 1"	96	100	13	60
MMEST8	G 1"	96	135	13	60
MMEST9	G 1¼"	96	135	13	60
MMEST10	G 1¼"	96	220	13	60
MMEST11	G 1½"	96	220	13	60
MMEST12	G 1½"	140	135	13	75
MMEST13	G 1½"	140	115	13	75
MMEST14	G 1½"	140	155	13	75
MMEST15	G 2"	140	155	13	75
MMEST16	G 2"	140	215	13	75
MMEST17	G 2"	140	265	13	75
MMEST18	G 2½"	140	277	25	101
MMEST19	G 3"	140	325	25	101

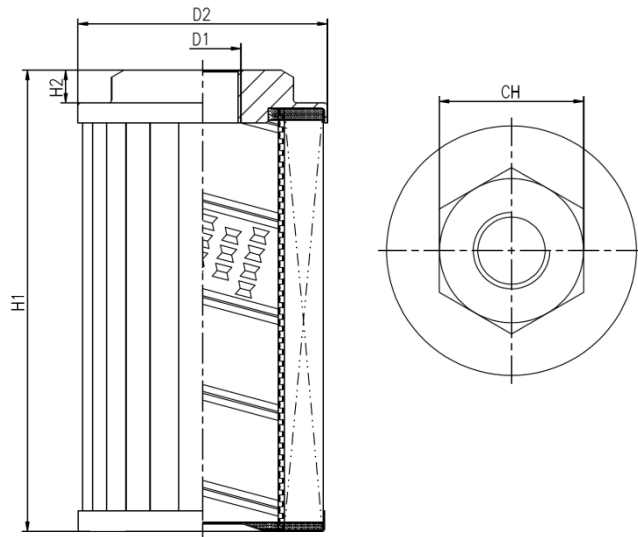

Order information

Element part number

Element				
	Type	Size	By-pass	Media
	MMEST	Table 1	Table 2	Table 3
Example	MMEST	3	O2	W60

Tables

Table 1	
Size	Flow rate (l/min)
MMEST3	20
MMEST4	25
MMEST5	35
MMEST6	40
MMEST7	50
MMEST8	60
MMEST9	80
MMEST10	100
MMEST11	150
MMEST12	110
MMEST13	150
MMEST14	180
MMEST15	200
MMEST16	230
MMEST17	250
MMEST18	330
MMEST19	500

Table 2	
By-pass	Open pressure
00	No by-pass
O2	0.3 bar
X	Special

Table 3			
Media	Material	Filtration	Collapse
W60	Wire mesh	60 µm	1 bar
W90	Wire mesh	90 µm	1 bar
W250	Wire mesh	250 µm	1 bar

Technical specification subject to change without prior notice. Other specification on request. 2013/07/23

